



Flat 11, 68 Longhorn Avenue, Gloucester, Gloucestershire, GL1 2BW

£1,000 PCM

TO LET

CHOSEN  
ESTATE AGENTS

- AVAILABLE 9/12/25
- BATHROOM
- GARAGE
- EDGE OF GLOUCESTER
- COUNCIL TAX BAND B
- EN-SUITE
- SITTING/DINING ROOM
- BALCONY
- TWO BEDROOMS
- EPC C

## THE PROPERTY

Chosen Estate Agents are delighted to present this two double bedroom top floor flat located in the popular Longhorn Avenue, Gloucester

This modern two-bedroom apartment offers stylish and convenient living on the edge of Gloucester City Centre, close to local amenities, transport links and the historic docks.

The accommodation comprises a spacious sitting room with access to a private balcony, a fitted kitchen, two double bedrooms with an en-suite shower room to the master, and a modern family bathroom.

Further benefits include double glazing, gas-fired central heating, a garage and on street parking

Perfect for a professional single or couple seeking contemporary, low-maintenance living within easy reach of the city center

Sorry no pets due to the head lease

Holding Deposit: £230.00 based on 1 weeks' rent of asking price

Security Deposit: £1,153.00 based on 5 weeks' rent of asking price

Council Tax band: B Local Authority: Gloucester City

EPC Band: C

Electricity supply: Mains Water supply: Mains Sewerage: Mains

Heating: Gas central heating Mobile phone coverage: i.e EE, Vodafone, Three, O2

If satisfactory references are not obtained or you withdraw your application any financial loss to Chosen Estate Agents or the Landlord will be deducted from your holding deposit. If you or your guarantor provides information that is inaccurate, false, incomplete, or adverse credit not being disclosed then we may retain your holding deposit and reject your application.

## SITUATION

Two bedroom third floor flat to rent in Longhorn Avenue, Gloucester GL1. Contact Farr & Farr on 01452 857421.

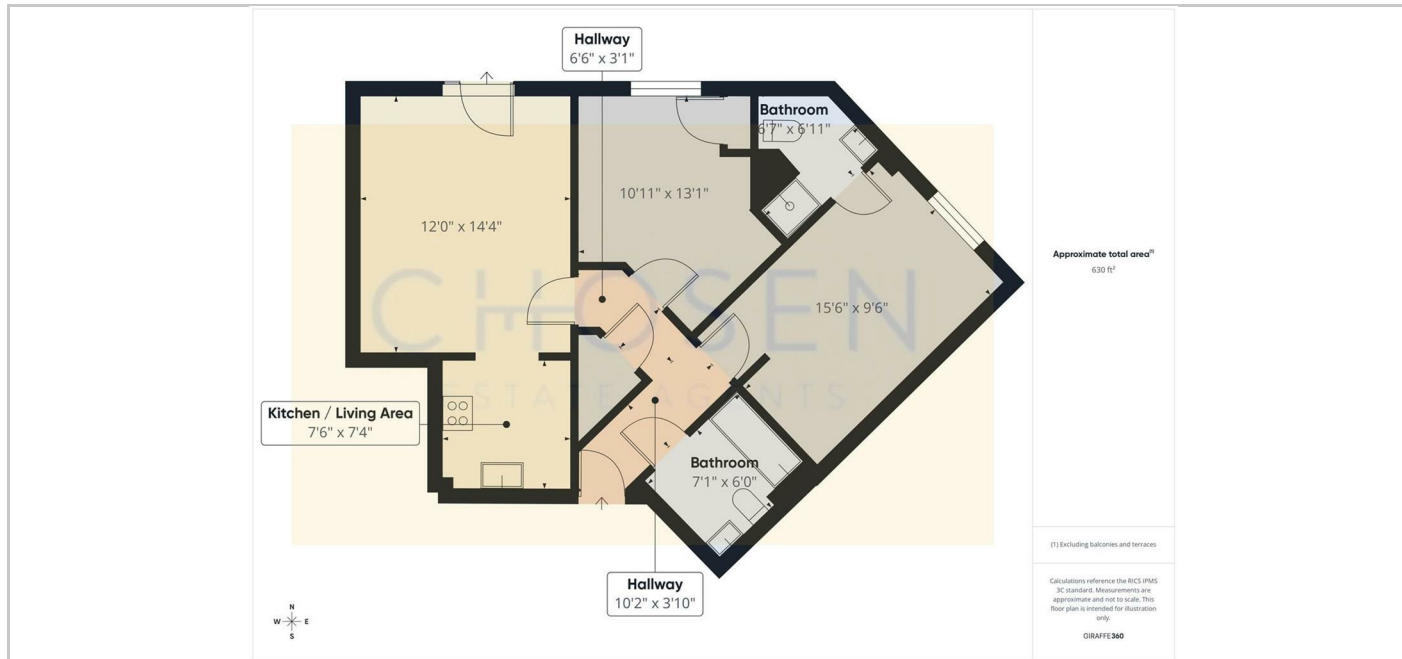

## Directions

2 Church Road, Churchdown, Gloucestershire, GL3 2ER

Tel: 01452 857421 Email: [info@chosenestateagents.co.uk](mailto:info@chosenestateagents.co.uk) [www.chosenestateagents.co.uk](http://www.chosenestateagents.co.uk)